

Obstetric Assistant Model Set (Obstetric Model - Vulva II)

LM-101B

Instruction Manual

Thank you for purchasing the LM-101B Obstetric Assistant Model Set(Obstetric Model - Vulva II).
Please read this instruction manual carefully to ensure correct use of the product,
and store it in a safe place for easy access.

KOKEN CO., LTD.

1-4-14 Koraku, Bunkyo-ku, Tokyo 112-0004 JAPAN

URL:<http://www.kokenmpc.co.jp>

E-mail:customer@kokenmpc.co.jp



Handling and Safety Precautions

These precautions should be strictly observed in order to ensure safe, long-term use of the product.

The following precautions should be observed particularly strictly:

Obstetric model - vulva II and the umbilical cord kit (for tying and cutting)

1. This model is made with a special material to simulate the texture of human skin. Please handle it with the same care that you would exercise when working with a human body. Pulling it with excessive force or subjecting it to strong impact, such as dropping it, may cause damage.
2. The material of this model has a distinct odor, which fades with time. This odor is not harmful to the human body and does not indicate poor quality. There may also be a baby powder smell remaining on the product, as baby powder is applied to the models during fabrication.
3. Wear disposable gloves when handling the model.
4. Use glycerin to lubricate the models. Be sure to apply a sufficient amount of lubricant (glycerin) to the model before use. Koken is not responsible for deterioration or damage occurring from use of lubricants other than glycerin. Use commercially available glycerin if you run out of the glycerin provided with the model.
5. Placing objects directly on top of the model or placing the model on uneven surfaces may result in deformation.
6. Do not use rubbing alcohol, thinners, benzene or other similar organic solvents on the model, as doing so may cause damage.
7. Do not use oil-based inks, pencil, chalk, or paints on the model, as they will soak into the material and cannot be removed.
8. If the surface becomes sticky after washing the model, generously apply baby powder to the model to reduce friction.
9. The model may lose its shape after a long period of time. Check the shape of the model around 3 years after purchase. If it is deformed to the extent that functioning is affected, please consider ordering a replacement.
10. Air bubbles or impressions in the model that may remain from the fabrication process do not affect the strength of the material, as the material used is highly tear-resistant.
11. This model is washable. After washing, wipe off the remaining water with a soft, dry gauze or cloth, and pat baby powder all over the model. **(Do not clean the model with rubbing alcohol, thinners, benzene or other similar organic solvents.)**

12. Storing the model for an extended time in a high or low temperature environment may result in deformation. Exposure to direct sunlight or UV rays may also alter its shape or color. Store the model in a 0-50° C environment, in a place where it will not be exposed to direct sunlight or UV rays.
13. Oil may leak from the model. For proper storage, wrap the model in paper towels, gauze, or another type of cloth, and place it in the re-sealable plastic bag that came with the kit.

Fetal model and placenta model

1. Please handle this model with the same care that you would exercise when working with a human body. Excessive force may result in damage to the model.
2. When delivering the placenta, avoid pulling too strongly on the umbilical cord.
3. Using the umbilical cord clip on the placenta model umbilical cord may cause it to tear. Use the umbilical cord clip on the umbilical cord for tying and cutting.
4. Clamping the placenta model umbilical cord tightly with hemostatic forceps or clamping with the base of the grip may tear the model. When using hemostatic forceps on the placenta model umbilical cord, clamp lightly and avoid using the base of the grip.

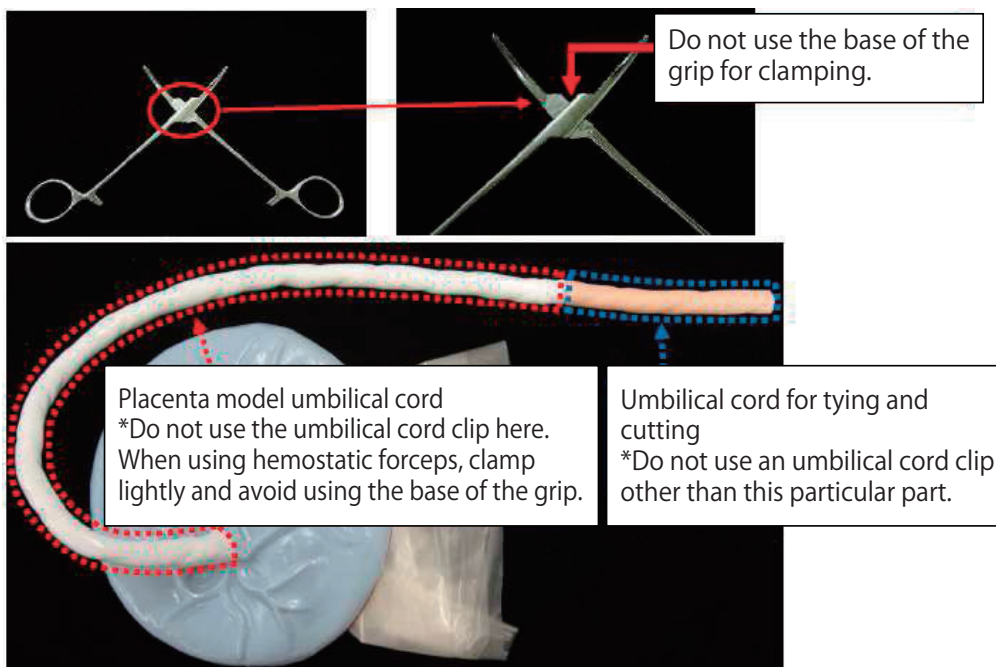

5. Wash smudges or marks off the model with water. To clean stubborn smudges or marks, wash with a neutral solvent diluted with water. After washing, wipe off the remaining water with a soft, dry gauze or cloth.

*Do not clean the model with rubbing alcohol, thinners, benzene or other similar solvents.

6. Dropping the model or subjecting it to strong impact could cause damage.

7. Store the model in a place where it will not be exposed to direct sunlight or UV rays.

1. The contents of this instruction manual are subject to change without notice.
2. This instruction manual may not be reproduced in part or in its entirety without permission.
3. Please contact the manufacturer in the event that any errors or omissions are found in the contents of this instruction manual.
4. This product should be used only as described in this instruction manual. In particular, the product should not be used in any way that contravenes the precautions noted in the instruction manual.

Table of Contents

1. Outline and Features
2. Parts of the Obstetric Assistant Model Set
3. Using the set
4. Caring for the Model
5. Specifications
6. Accessories and Optional Items

1. Outline and Features

Outline

This set allows trainees to practice a series of obstetric assistance techniques, such as protection of the perineum and inspection of the fetus and placenta.

Features

- The obstetric model - vulva II is made with a highly elastic and durable material that decreases resistance and reduces the amount of force needed to extract the fetus during delivery, enabling smooth practice.
(Use glycerin to lubricate.)
- Protection of the perineum can be practiced.
- Breech extraction can also be practiced as one type of emergency response.
- The umbilical cord is soft and slides away from scissors when being cut, so that each one can be used multiple times to practice tying and cutting. The fetal model and placenta model can be attached to practice the entire sequence of steps from delivering the fetus to tying the umbilical cord, cutting the umbilical cord, and delivering the placenta.
- The placental membrane laceration part can be detached into three parts for inspection of the placenta and checking whether or not the membrane is intact.

2.Parts of the Obstetric Assistant Model Set

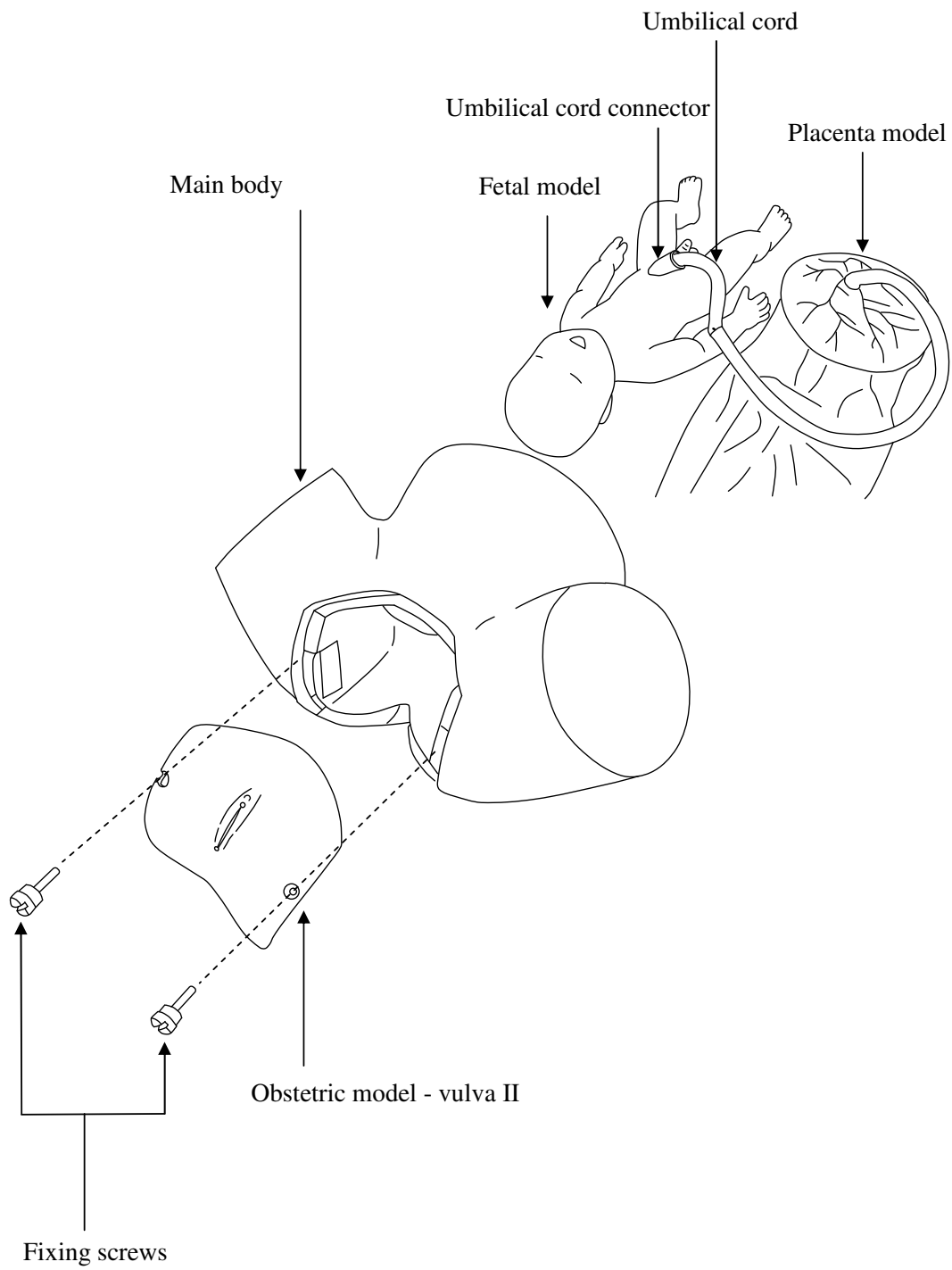

3. Using the set

3-1. Attaching the obstetric model - vulva II

Place the obstetric model - vulva II on the main body, and secure it in place with the fixing screws. (A flat-head screwdriver is required.)

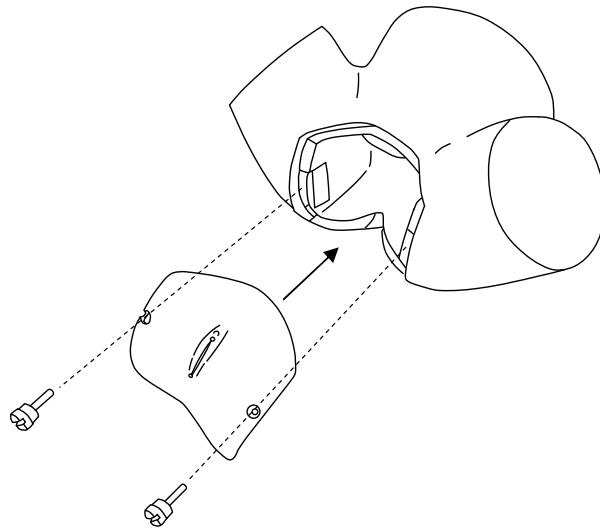

3-2. Attaching the fetal model and placenta model

1. Hold the umbilical cord and roll down the end with a hole until a string loop appears.

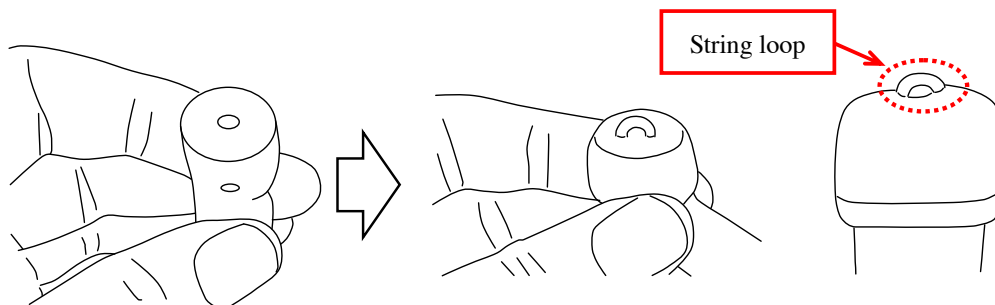

2. Roll down the end of the umbilical cord attached to the placenta model (LM-0634) until a hook appears on the end.

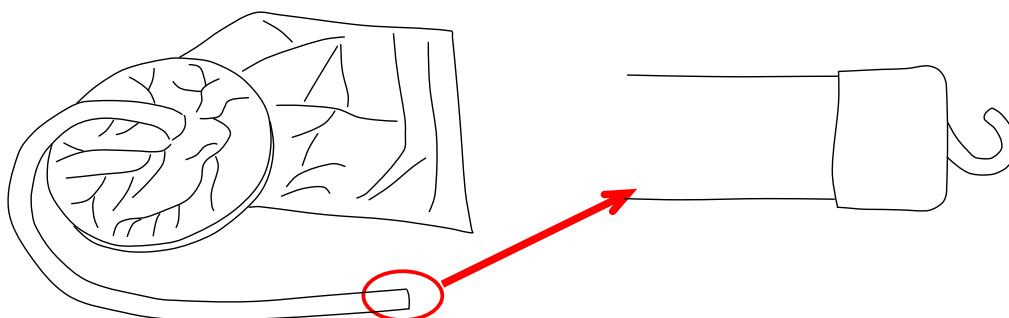

3. Place the hook of the placenta model on the string loop of the umbilical cord. Unfold the edges of the ends that were rolled down so that the end of the umbilical cord of the placenta model covers the umbilical cord.

*If the umbilical cord is not partially covered by the umbilical cord of the placenta model, they may come apart during delivery.

*Make sure the parts are not lubricated when attaching them together, as it will be difficult to slide the umbilical cord of the placenta model over the umbilical cord if they are lubricated with glycerin or another lubricant during this step.

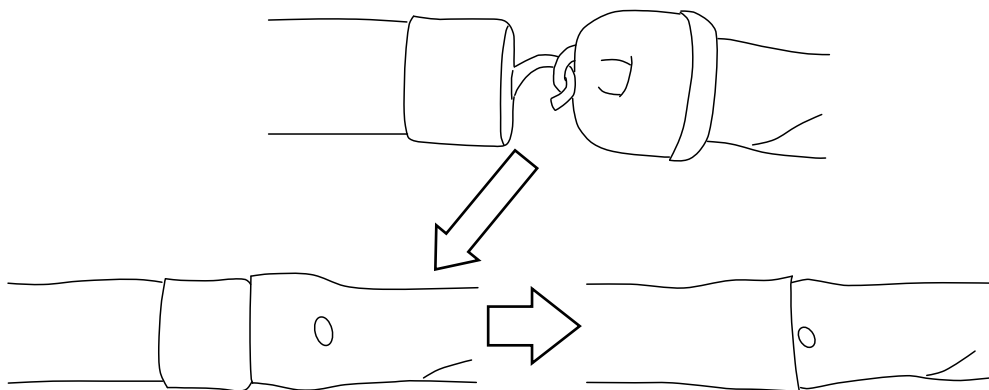

4. Roll down the end of the umbilical cord connector with a hook attached so that the hook is visible, then attach the hook to the umbilical ring on the fetal model (LM-0633). After attaching the hook, unfold the end.

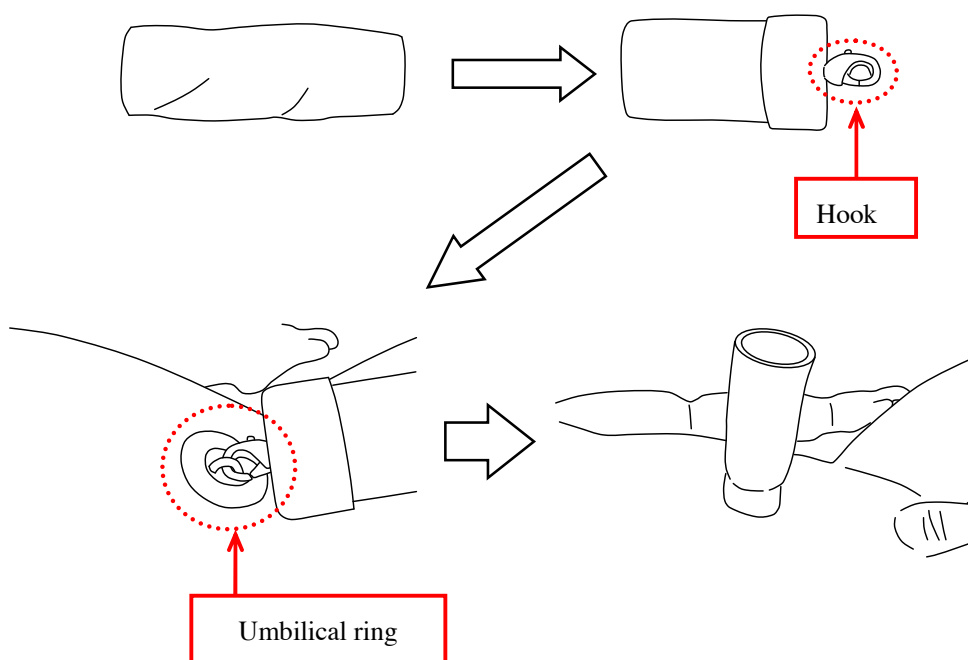

5. Roll down the end of the umbilical cord connector with the clip so that the clip is visible, then clamp it onto the umbilical cord. After clamping them together, unfold the end of the umbilical cord connector and roll it over the umbilical cord for tying and cutting.

*If the umbilical cord is not partially covered by the umbilical cord connector, they may come apart.

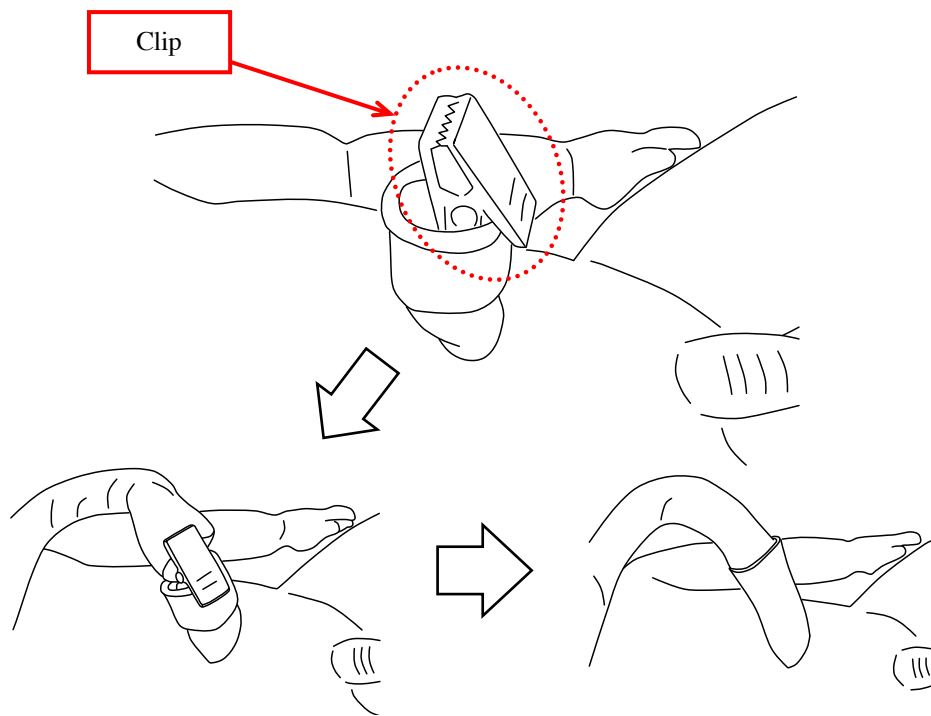

6. Assembly is now complete. To re-attach the umbilical cord after it is cut off, start the procedure again from step 5.

*Apply a sufficient amount of glycerin to both the fetal and the placenta models when practicing delivery.



*Air bubbles or impressions in the model that may remain from the fabrication process do not affect the strength of the material, as the material used is strongly tear-resistant.

3-3. Applying lubricant

Apply a generous amount of glycerin to the backside of the obstetric model - vulva II, the head and shoulders of the fetal model, and the placenta model.

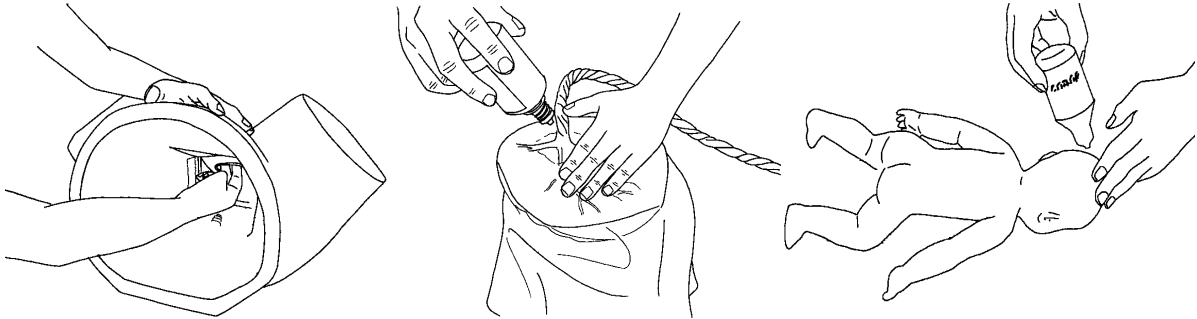

3-4. Holding the fetal model

Hold down the back of the head of the fetal model with your index finger to keep it from facing upwards. The figures below show one way to hold the model.

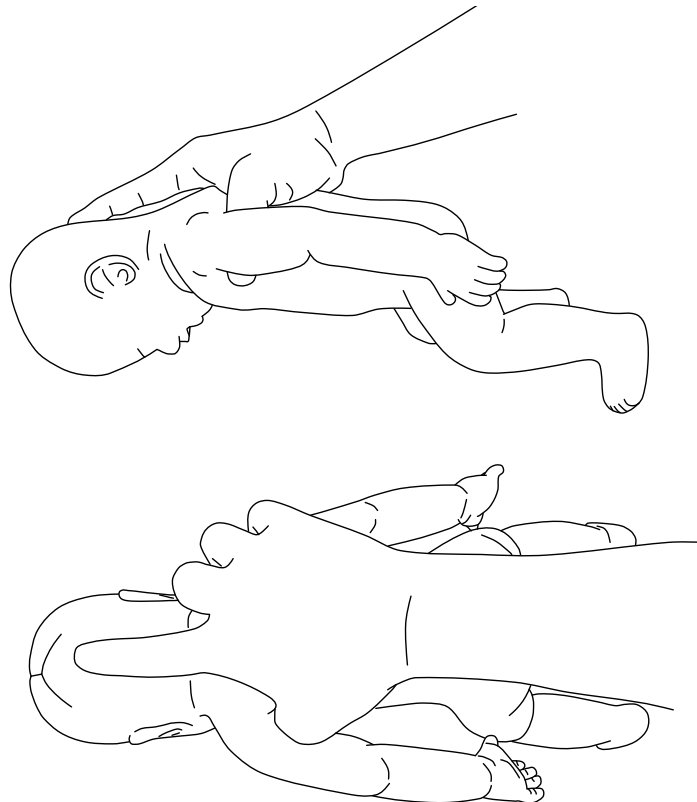

4. Caring for the Model

4-1. Cleaning the main body

To clean smudges or marks off the main body, wipe with a towel or cloth moistened with water.

*Do not wash the main body.

4-2. Cleaning the fetal model and placenta model

Both the fetal model and the placenta model can be washed normally in water.

After washing, wipe off all the remaining water with a soft, dry gauze or cloth.

4-3. Cleaning the obstetric model - vulva II

1. Rub the surface lightly while washing off the lubricant (glycerin) applied during practice with water.

*Do not clean the model with rubbing alcohol, thinners, benzene or other similar solvents.

*When washing the model, do not dig your nails into the surface or apply strong force.

This may result in damage.

2. Wipe off the lubricant along with dirt or smudges, and all the remaining water with gauze or a soft cloth. Then, pat baby powder all over the model.

*Water remaining on the model after washing may cause mold to develop. Make sure to thoroughly wipe off all the water.

3. Wrap the model in the included paper towels, or in gauze or another type of cloth, and place it in the re-sealable plastic bag that came with the kit. Store it in a 0-50° C environment where it will not be exposed to direct sunlight or UV rays.

5. Specifications

Product name	Quantity	Size			
		Length	Width	Height	Weight
Main body	1	Approx. 30 cm	Approx.51 cm	Approx.28cm	Approx. 2.8kg
Obstetric model - vulva II (primipara type)	1	Approx. 17 cm	Approx.17 cm	Approx. 8cm	Approx. 600g
Fetal model	1	Head circumference Approx. 30 cm	Height Approx. 40 cm	Weight Approx. 2030 g	
Placenta model	1	Diameter Approx. 19 cm	Umbilical cord length Approx. 51 cm	Weight Approx. 660 g	
Umbilical cord (for tying and cutting)	3	Total length Approx. 12 cm	Diameter Approx. 1.4 cm	Weight Approx. 16 g	
Umbilical cord connector	1	Total length Approx. 4 cm	Diameter Approx. 1.6 cm	Weight Approx. 7 g	
Fixing screw	2				

6. Accessories and Optional Items

Accessories

Product name	Quantity
Cloth cover for main body	1
Glycerin	1
Instruction manual	1

Optional items

Product name	Product No.
Umbilical cord kit (1 umbilical cord connector, 1 umbilical cord)	LM-101D
Umbilical cord for replacement (10 pcs)	LM-101E
Obstetric model - vulva II (primipara type)	LM-101P
Obstetric model - vulva II (multipara type)	LM-101M
Obstetric model - vulva II set (primipara and mutipara type)	LM-101S